

SOYBEAN MANAGEMENT FIELD DAYS

Over 25 years of providing unbiased, research-based information

Soybean growers are faced with complex production and marketing challenges. Soybean Management Field Days help address issues that are important to farmers and look at the challenges faced on the home front and internationally.



Aug. 13 Holdrege

Blake Johnson farm

Coming from East – From the intersection of U.S. 34 and Highway 183 in Holdrege, head west on U.S. 34/U.S. 6 W/W 4th Avenue for .5 miles, then take a slight right to head west onto NE-23W for 1.6 miles, then turn north onto L Road for .6 miles, then turn west onto W 18th Ave/733 Road for .2 miles.

Coming from West – From Loomis, head southeast on Highway 23 for 4.1 miles, then turn east onto 733 Road for .9 miles. *Shop is on north side of the road.*

Google map: <https://go.unl.edu/smfd1>



Aug. 14 Neligh

Kenny Reinke farm

Coming from North – From the intersection of U.S. 20 and Highway 14, go south for 6.8 miles on Highway 14, then turn east onto 857th Road and continue east for ½ mile.

Coming from South – From the intersection of Highway 275 and 14 in Neligh, go north for 8 miles on Highway 14, then turn east onto 857th Road and continue east for ½ mile. *Shop is on south side of the road.*

Google map: <https://go.unl.edu/smfd2>



Aug. 15 Ulysses

Scott Richert farm

Coming from North – From Highway 92 ½ mile west of Rising City, turn south on NE-12E spur, head south for 6 miles, continue south through Surprise on Miller St/Road D for 4 miles, then turn east onto Road 21/Ashland Road and head east for ½ miles.

Coming from South - From Gresham, head north on Highway 69 one mile, turn east onto Road 121 and head east for 5 ½ miles. *Field is on south side of the road.*

Google map: <https://go.unl.edu/smfd3>

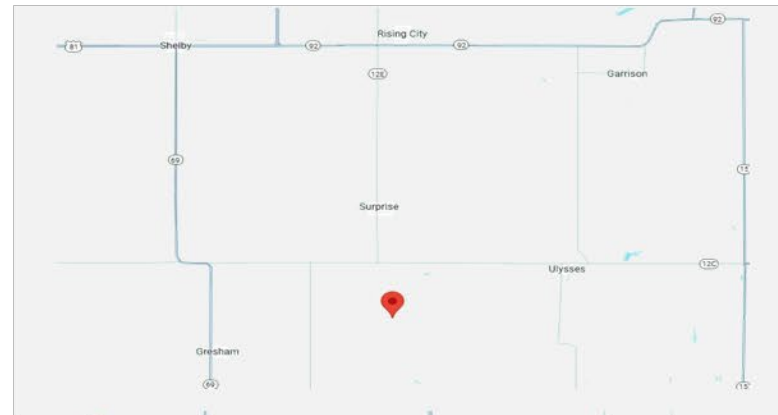

Aug. 16 Mead

UNL Eastern NE Research, Extension & Education Center

Coming from North – From Highway 92 by Mead, turn south onto Road 10 and head south for 5 miles, then turn east onto County Road I and follow County Road I east and then north past the UNL farm shop.

Coming from South – From the intersection of Highway 66 and Road 10, head north for 2 miles on Road 10, then turn east onto County Road I and follow County Road I east and then north past the UNL farm shop. *Field is on north side of the road.*

Google map: <https://go.unl.edu/smfd4>

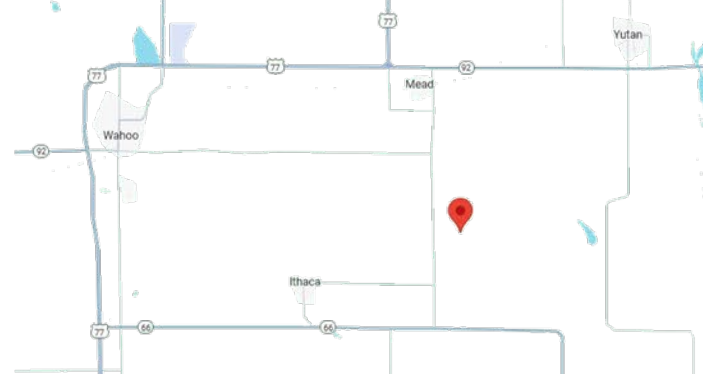

Aug 13 - Holdrege, NE (Blake Johnson farm)
Aug 14 - Neligh, NE (Kenny Reinke farm)
Aug 15 - Ulysses, NE (Scott Richert farm)
Aug 16 - Mead, NE (UNL Eastern Nebraska REEC)



Eastern Nebraska Research,
Extension & Education Center
1071 County Road G
Ithaca, NE 68033



2024 SOYBEAN MANAGEMENT FIELD DAYS



6:00 to 8:00 p.m.
Aug 13 – Holdrege, NE
Aug 14 – Neligh, NE
Aug 15 – Ulysses, NE

10:30 a.m to 2:00 p.m.
Aug 16 – Mead, NE



University of Nebraska–Lincoln
Institute of Agriculture and Natural Resources

Extension is a Division of the Institute of Agriculture and Natural Resources at the University of Nebraska–Lincoln cooperating with the Counties and the United States Department of Agriculture. University of Nebraska–Lincoln Extension educational programs abide with the nondiscrimination policies of the University of Nebraska–Lincoln and the United States Department of Agriculture. Copyright 2023.

2024 SOYBEAN MANAGEMENT FIELD DAYS

- Four days, four locations
- Each day featuring a different focus
- Sessions with interactive discussion
- Complimentary meal



Over 25 years of providing growers with the latest in soybean production, management and marketing, now incorporating a Soybean TAPS competition focusing on profitability.

Don't miss this opportunity to learn about the latest techniques and technologies in soybean production, while also networking with fellow farmers and industry experts.

- Learn best practices you can implement in your fields
- Discuss issues important to you - county specific to worldwide
- Learn about what the Nebraska Soybean Board is doing in research, marketing and education



Tuesday, Aug. 13 – Holdrege NE (Blake Johnson farm)

6:00 p.m. to 8:00 p.m. (5:30 p.m. – Registration)

Topics – Soybean TAPS competition, dectes stem borer, and irrigation management

14 teams are competing in the 1st annual Soybean TAPS competition this summer, including our host farmer, Blake Johnson. Learn what's new from this inaugural event, along with dectes stem borer management and new tools for irrigation scheduling.

- Chris Proctor, Nebraska Weed Management Extension Educator
- Justin McMechan, Crop Protection and Cropping Systems Specialist
- Bruno Patias Lena, Nebraska Extension Educator
- Todd Whitney, Nebraska Extension Educator

Wednesday, Aug. 14 – Neligh, NE (Kenny Reinke farm)

6:00 p.m. to 8:00 p.m. (5:30 p.m. – Registration)

Topics – Soybean TAPS competition, white mold, and irrigation management

14 teams are competing in the 1st annual Soybean TAPS competition this summer. Hear what our host farmer, Kenny Reinke, has learned competing in past TAPS competitions, along with current research being conducted on controlling white mold and new tools for irrigation scheduling.

- Dylan Mangel, Nebraska Extension Plant Pathologist
- Amy Timmerman, Nebraska Extension Educator
- Chris Proctor, Nebraska Weed Management Extension Educator
- Bruno Patias Lena, Nebraska Extension Educator

Thursday, Aug. 15 – Ulysses, NE (Scott Richert farm)

6:00 p.m. to 8:00 p.m. (5:30 p.m. – Registration)

Topics – Soybean TAPS competition and on-farm research on biological seed treatments

14 teams are competing in the 1st annual Soybean TAPS competition this summer. Learn what's new from this inaugural event and a behind the scenes tour of an on-farm research trial being conducted on biological seed treatment for soybeans seeded into a rye cover crop.

- Jenny Rees, Nebraska Extension Educator
- TJ Prochaska, Nebraska Extension Educator
- Chris Proctor, Nebraska Weed Management Extension Educator

Friday, Aug. 16 – Mead, NE (UNL Eastern Nebraska Research, Extension & Education Center)

10:30 a.m. to 2:00 p.m. (10:00 a.m. – Registration)

Topics – Tour of the Soybean TAPS competition plots, Ag Olympics, & tour of soybean gall midge trials

Join us Friday morning to tour the the inaugural Soybean TAPS competition plots. We'll discuss management decisions made by the 14 participating teams and share initial impressions. After lunch, you'll have the option to test your knowledge in a fun Ag Olympics competition or tour soybean gall midge research being conducted on-site.

- Chris Proctor, Nebraska Weed Management Extension Educator
- Justin McMechan, Crop Protection and Cropping Systems Specialist
- Dylan Mangel, Nebraska Extension Plant Pathologist
- Bruno Patias Lena, Nebraska Extension Educator

Please register 2 days in advance by going to go.unl.edu/soydays, scanning the QR code, or by calling 402-624-8030



Maps, additional topic info, and more:

enrec.unl.edu/soydays

Questions: 402-441-3240

